



Manufacturer of shut-off and control valves

TECHNICAL DATA SHEET

Gate gate valve ELEPHANT GVKN3431M-1W-Fb-S DN50-200 10 bar carbon steel, interflanged with hand wheel



+34 900 433 073, sales@valveelephant.com
Carrer d'Aragó,264,3-1,08007 Barcelona, Spain

1. GENERAL INFORMATION ABOUT THE PRODUCT

- 1.1. Product name: Gate valve ELEPHANT GVKN3431M-1W-Fb-S DN50-200 10 bar carbon steel, interflanged with hand wheel.
- 1.2. Purpose: The gate valve is designed for installation on the pipeline as a shut-off device in water treatment systems and chemical industry. Metal/metal type seal allows to use the gate valve for transportation of media containing high amount of abrasive particles.



1.3 Deciphering the designation:

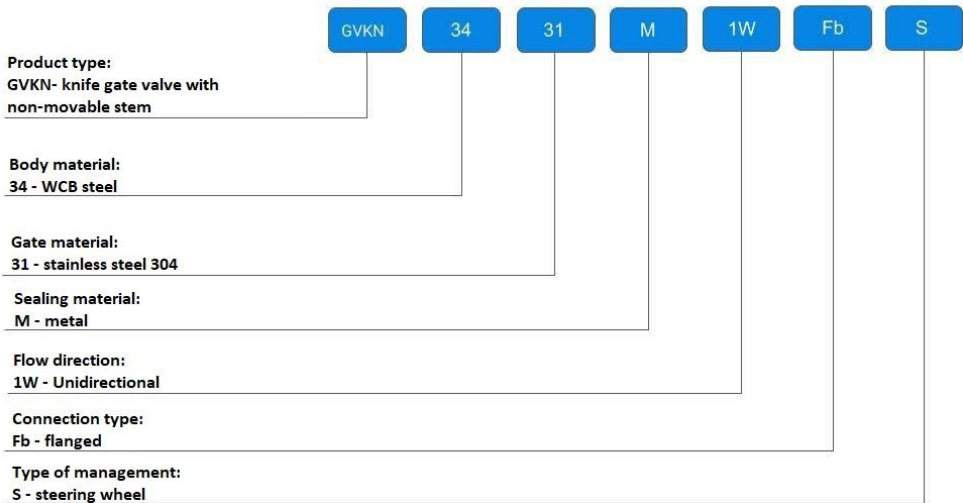

BASIC TECHNICAL DATA AND CHARACTERISTICS

Nominal diameter DN, mm	50 – 200
Nominal pressure, bar	10
Flow direction	one-sided
Medium temperature, °C	-30 to 400
Tightness in the gate	B
Medium	Wastewater, slurry, viscous, powdered and crystallized media, acids
Pipeline connection	interflange
Control type	handwheel
Gate type	single disc
Stem	non-sliding
Body material	WCB steel
Slide gate material	stainless steel AISI 304



MATERIAL INFORMATION FOR MAJOR PARTS

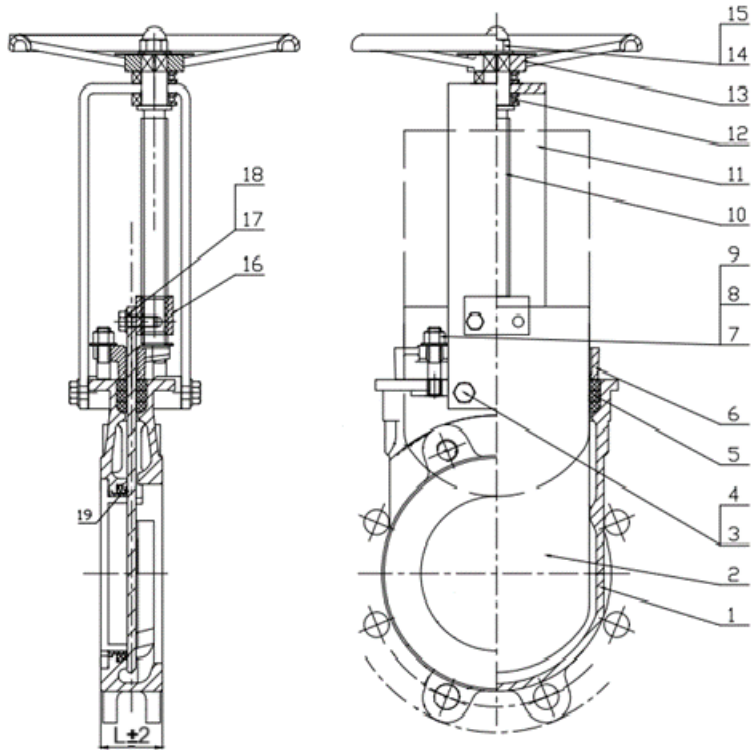

Nº	Product Name	Material	Nº	Product Name	Material
1	Body	WCB steel	11	Support plates	A3 steel
2	Disc	steel 304	12	Bearing	ZChSnSb10-6
3 - 4	Bolt / Nut	steel A3	13	Hand wheel	cast iron QT450
5	Seal	METAL	14 - 15	Bolt / Nut	A3 steel
6	Gland	steel WCB	16	Stem nut	cast iron QT450
7 - 9	Bolt / Nut	steel A3	17 - 18	Bolt / Nut	A3 steel
10	Stem	steel 2Cr13	19	Support	steel 304



BASIC DIMENSIONS OF GATE VALVES

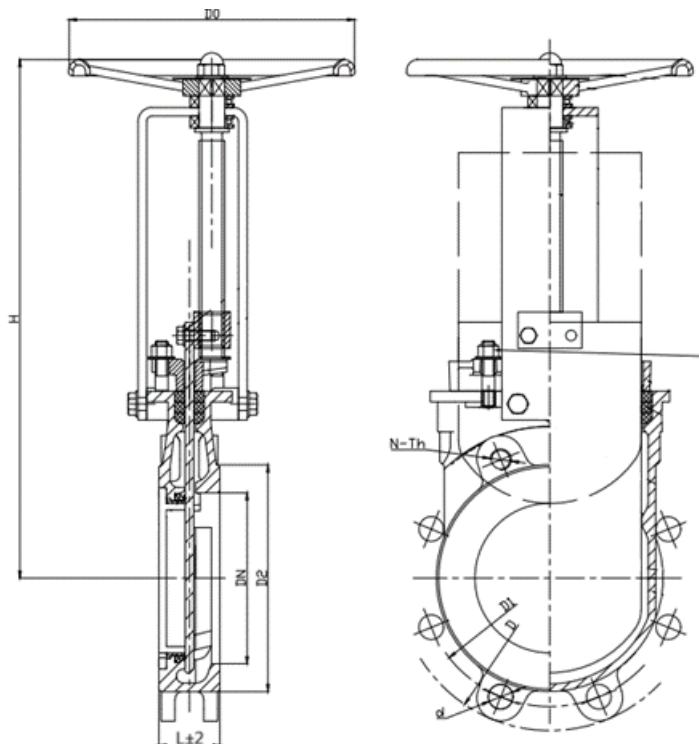

DN	L	D	D1	D2	D0	N-Th	d	H	Weight, not more
									kg
mm									
50	48	160	125	99	180	4-M16	Ø18	290	7
80	51	195	160	132	220	8-M16	Ø18	350	10
100	51	215	180	156	240	8-M16	Ø18	385	13
150	57	280	240	212	280	8-M20	Ø23	485	23
200	70	335	295	266	300	8-M20	Ø23	565	30



INSTALLATION AND OPERATION

1. Recommended position of the gate valve on the pipeline:
 - VERTICAL (hand wheel or upward drive) on a horizontal pipeline.
 - HORIZONTAL (with hand wheel or actuator to the side) on horizontal and vertical pipelines.
 - **THE SLIDE GATE VALVE MUST NOT BE INSTALLED WITH THE HAND WHEEL OR ACTUATOR DOWNWARDS!**
2. During installation, gaskets must be installed between the flanges of the gate valve and the pipeline.
3. If the pipeline sections are not permanently fixed to permanent supports, they must be temporarily fixed. This is necessary to avoid unnecessary mechanical stress on the gate valve, possible damage.
4. Bolts (for blind holes) and studs (for through holes) are used to mount the gate valve. **DO NOT** use 2 bolts connected by an extended nut instead of studs. Bolts and studs must be tightened evenly crosswise in several passes.
5. It is not allowed to mount the gate valve pre-mounted with flanges and then weld the flanges to the pipe. This method of installation may cause metal splashes to get and stick to the gate valve blade, which will lead to failure of the gland seal and leakage through the gland. It is also possible to damage the gate valve seat seal with molten metal splashes, as a result of which the gate valve may lose its ability to hermetically shut off the flow.

During inspection check: general condition of the gate valve; threaded part of the spindle, which should be lubricated); condition of bolted connections; tightness of the gasket connection and gland seal.



WARRANTY PERIOD

Warranty period - 12 months from the date of commissioning, but not more than 18 months from the date of sale.

The warranty does not apply:

- parts and materials of the product subject to wear and tear
- for cases of damage caused by:
 - violations of the product storage, installation, testing, operation and maintenance specifications;
 - improper transportation and handling operations;
 - the presence of traces of exposure to substances aggressive to the product materials;
 - presence of damage caused by fire, elements, force majeure circumstances;
 - damage caused by incorrect actions of the consumer;
 - traces of tampering with the design of the product.

SALES MARK

No	Product Name	Packs

Date of sale: _____

L.S.



